

ELECTROMAGNETIC COMPATIBILITY / PRODUCT SAFETY

EMC TEST CENTER FOR LARGE SYSTEMS

Test range: 16 Hz to 40 GHz

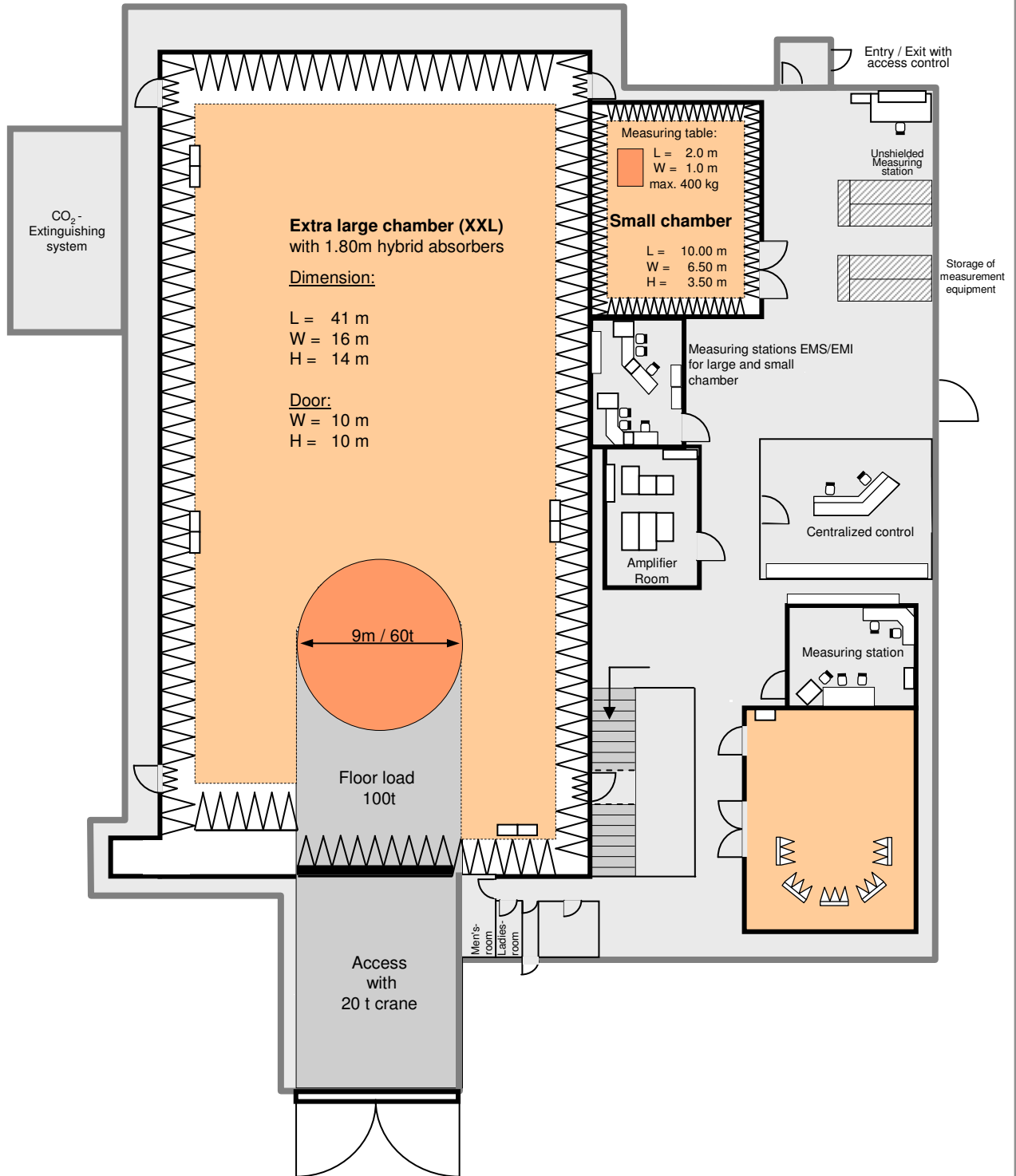

SGS Germany GmbH
Center for Quality Engineering

Hofmannstr. 50
81379 Munich

Phone.:
Fax:
e-mail:
internet:
contact:

+49 89 / 787475-100
+49 89 / 1250406-4100
cqe@sgs.com
www.sgs-cqe.de
Armin Hudetz – Phone: +49 89 / 787475-133

ELECTROMAGNETIC COMPATIBILITY / PRODUCT SAFETY

Technical details

Extra large chamber (XXL)

Dimensions Chamber:	41 m x 16 m x 14 m		
Dimensions Door:	10 m x 10 m		
Turntable:	Diameter: 9 m, 360° rotatable, load capacity: 60 t		
Floor load:	100 t/m ²		
Shielding effectiveness:	>100 dB; 10 kHz to 18 GHz according to Mil-Std 285		
Normalised site attenuation:	Deviation <4 dB according EN 50147-2, ANSI C64.3		
Field uniformity:	Deviation <6 dB according IEC 61000-4-3		
Amplifiers:	0.2 to 10 kW - 10 kHz to 18 GHz; Field strength up to 200 V/m		
Receivers:	16 Hz to 40 GHz		
Exhaust extraction:	30.000 m ³ /h		
Monitoring systems:	4 stationary video cameras + 3 mobile video cameras Acoustic supervision with acoustic modules		
Power supply:	125 A fused:	230 V / 50 Hz	1 phase
		400 V / 50 Hz	3 phases
		220 V / 60 Hz	1 phase
		380 V / 60 Hz	3 phases
		120 V / 60 Hz	1 phase
	63 A fused:	208 V / 60 Hz	3 phases
		120 V / 400 Hz	1 phase
		208 V / 400Hz	3 phases
		0-100 V DC	adjustable
		28V DC	constant